

Physical Specification

| | | |
|-------------------------|-------------------------|-----------------------------|
| Nominal Voltage | | 12.8V |
| Nominal Capacity (10Hr) | | 8.0 Ah |
| Dimension | Length | 166±2mm (6.54 inches) |
| | Width | 123±2mm (4.84 inches) |
| | Container Height | 163±2mm (6.42 inches) Total |
| | Height (with Terminal) | 163±2mm (6.42 inches) |
| Weight | Approx 1.51kg (3.33lbs) | |



- * Motorcycle Li-ion battery
- * Maintenance-free
- * Real-time protection (overcharge, over-discharge, over-temperature) and energy balance of battery system through BMS
- * Powerful 240 cold cranking amps
- * Shipped pre-charged and ready to install
- * Replaces EB30-3-1/EBX30L-BS/EB30-4-1/EBX30-BS/LB30L-B/LB30CL-B/L60-N24L-A/L60-N24AL-B/L60-N24-A/L60-N30L-A/L60-N30L-B/L60-N30-A/12N24-3A/12N24-4A battery

Electrical Specification

| | | |
|----------------------------------|---|-------|
| Rated Capacity | 0.1C rate (0.8A) | 8.0Ah |
| | 0.5C rate (4.0A) | 8.0Ah |
| | 10C rate (80.0A) | 7.2Ah |
| | 30C rate (240.0A) | 3S |
| Capacity affected by Temperature | 40 °C (104 °F) | 98% |
| | 25 °C (77 °F) | 100% |
| | 0 °C (32 °F) | 85% |
| | -20 °C (-4 °F) | 60% |
| Self Discharge | Approximately 1.5% per month (25°C (77°F)) | |
| Charging Methods | Constant-Voltage Charge: Full Charge Initial charging current: less than 0.8A Voltage: 14.40 V ~ 14.60 V at 25 °C (77 °F) | |

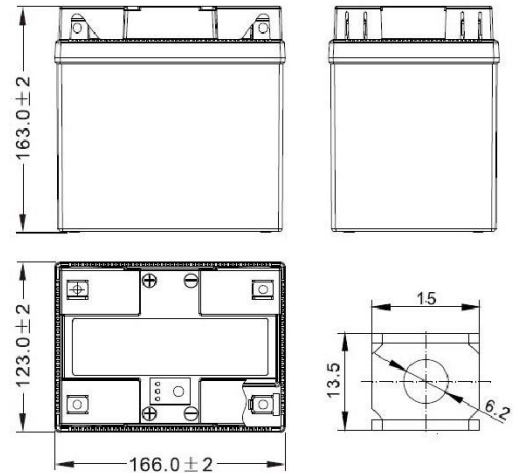

Dimensions (mm)

Curve Specification

