

### Physical Specification

Nominal Voltage		12.8V
Nominal Capacity (10Hr)		8.0Ah
Dimension	Length	166±2mm (6.54 inches)
	Width	123±2mm (4.84 inches)
	Container Height	163±2mm (6.42 inches) Total
	Height (with Terminal)	163±2mm (6.42 inches)
Weight	Approx 1.53kg (3.37lbs)	



- \* Motorcycle Li-ion battery
- \* Maintenance-free
- \* Real-time protection (overcharge, over-discharge, over-temperature) and energy balance of battery system through BMS
- \* Powerful 240 cold cranking amps
- \* Shipped pre-charged and ready to install
- \* Replaces EB30-3-1/EBX30L-BS/EB30-4-1/EBX30-BS/LB30L-B/LB30CL-B/L60-N24L-A/L60-N24AL-B/L60-N24-A/L60-N30L-A/L60-N30L-B/L60-N30-A/12N24-3A/12N24-4A battery

### Electrical Specification

Rated Capacity	0.1C rate (0.8A)	8.0Ah
	0.5C rate (4.0A)	8.0Ah
	10C rate (80.0A)	7.2Ah
	60C rate (480.0A)	3S
Capacity affected by Temperature	40 °C (104 °F)	98%
	25 °C (77 °F)	100%
	0 °C (32 °F)	85%
	-20 °C (-4 °F)	60%
Self Discharge	Approximately 1.5% per month (25°C (77°F))	
Charging Methods	Constant-Voltage Charge:	
	Full Charge Initial charging current: less than 4.0A Voltage: 14.40 V ~ 14.60 V at 25 °C (77 °F)	

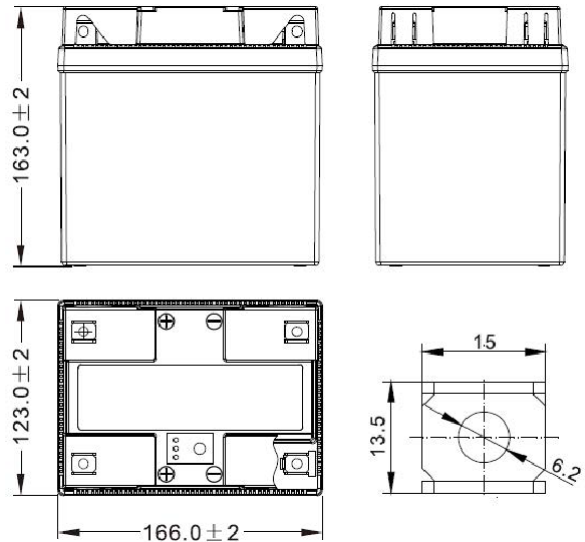

Dimensions (mm)

### Curve Specification

