

Lithium Iron Phosphate Battery

LFELi-48200T-SNMP (48V200Ah)



Features Of LiFePO4 Battery

- 20-year design life
- Extreme cycle life - up to 3500 cycles at 100% DOD
- Extreme temperature range: -4°F~140°F (-20°C~60°C)
- Advanced Battery Management System (BMS) - System monitoring of voltage, current and temperature
- Built-in overcharge, overdischarge and overheat protection
- Advanced BMS communication protocols - Modbus, RS232, RS485 and SNMP
- Anti-theft tracking systems available - GPS and Gyroscope
- Flexibility in configuration - Supports parallel connection of up to 40 modules
- Flame retardant system to UL94V-0 & >28% LOI
- Easy installation - 19"/23" standard cabinet or wall mounting



Physical Dimension-mm

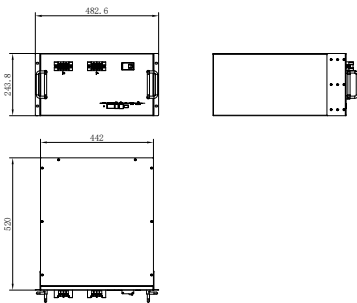

Typical Applications

- Access Network Equipment
- Remote Switching Offices
- Mobile Communication Equipment
- Transmission Equipment
- Satellite Ground Stations
- Microwave Communication Equipment
- Communication field as backup power supply

Item	Parameters
Model	LFELi-48200T-SNMP
Rated Capacity (5HR)	200 Ah
Nominal Voltage	48V
Discharge Ending Voltage	37.5V
Charging Limited Voltage	54.75V
Max. Charging/Discharge Current	100A
Weight	Approx. 79.2KG
Energy	9600Wh
Display	Without LCD display
Max. number of parallel connection	40
Dimensions (W*D*H) mm	442*450*244
Design Life	20 years
Cycle Life	3500 cycles
IP Class	IP20
Case Material	SPCC
Operating Temperature	Charging: 0 to +55°C, Discharging: -20 to +55°C, Storage: -5 to +35°C

Constant Current Discharge Table (Amperes) at 25°C

Voltage \ Time	2 h	4 h	6 h	10 h	20 h
End of discharge voltage 37.5V	100A	50A	33.3A	20A	10A

Constant Power Discharge Table (Watts) at 25°C

Voltage \ Time	2 h	4 h	6 h	10 h	20 h
End of discharge voltage 37.5V	4800W	2400W	1600W	960W	480W